



WARNING: To reduce the risk of injury, read the pressure washer instruction manual and the engine instruction manual before operating pressure washer.



IF YOU EXPERIENCE ANY ISSUES WITH YOUR PRESSURE WASHER, DO NOT RETURN TO COSTCO. WE ARE HERE TO HELP YOU.

CALL TOLL FREE 1-877-362-4271 www.SimpsonCleaning.com

SHOULD YOU REQUIRE ASSISTANCE WITH A PART THAT MAY BE BROKEN OR MISSING OR YOU ARE HAVING DIFFICULTY WITH ASSEMBLY OR STARTING PLEASE CONTACT US OR THE COSTCO CONCIERGE DESK AT **1-866-861-0450**. YOUR COMPLETE SATISFACTION IS OUR PRIMARY OBJECTIVE.

MSV3024 QUICK SETUP GUIDE

(Letters A-C)

A Install the Handle
Place handle onto frame, depress the snap buttons, and slide the handle assembly onto the frame until snap buttons snap into place.

B Add/Check Oil
The engine is shipped without oil. Before starting engine, add the oil provided using the oil spout. Check oil level prior to each use. Refer to Engine Owner's Manual for complete procedure.

C Add Gasoline
In a well ventilated outdoor area add fresh, high quality, unleaded gasoline with a pump octane rating of 86 or higher. Do not overfill. Wipe up spilled fuel before starting the engine. Refer to Engine Owner's Manual for complete procedure.

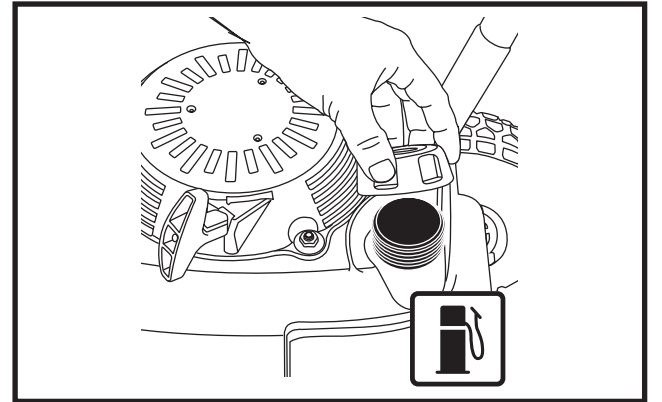
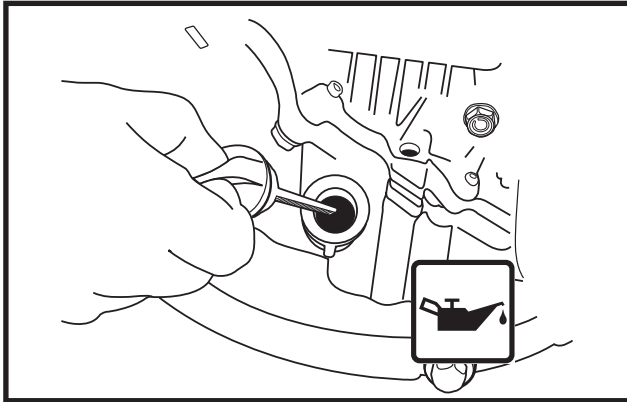
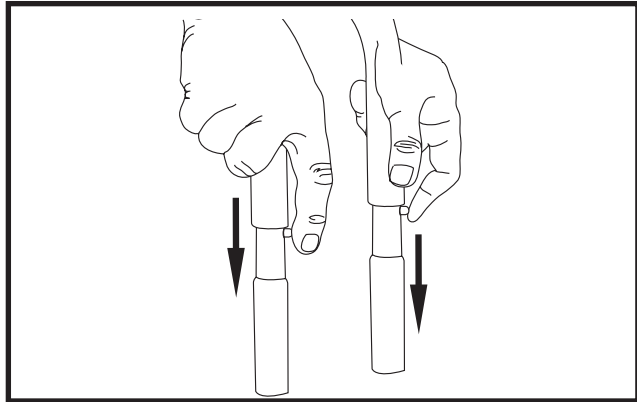

MSV3024 QUICK START GUIDE

(Numbers 1-12)



DANGER:

- Never run engine indoors or in enclosed, poorly ventilated areas. Engine exhaust contains carbon monoxide, an odorless and deadly gas.
- Risk of fluid injection and laceration. When using the high-pressure setting, DO NOT allow the high-pressure spray to come in contact with unprotected skin, eyes or with any pets or animals. Serious injury will occur.

1 Connect Garden Hose to Pump
Thread the garden hose to the pump inlet. See Label #1 on the back of the unit.

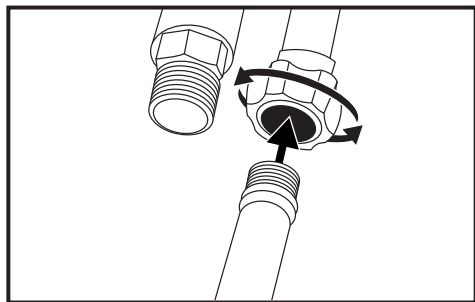

2 Connect High Pressure Hose to Pump
Thread the high pressure hose to the pump outlet. See Label #2 on the back of the unit.

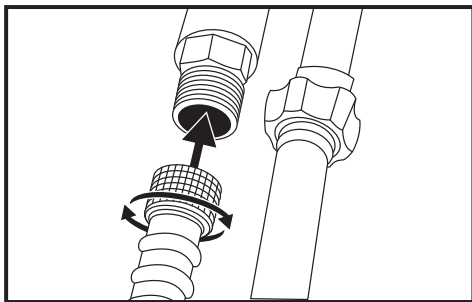

3 Connect High Pressure Hose to Spray Gun
Thread the other end of the high pressure hose to the spray gun.

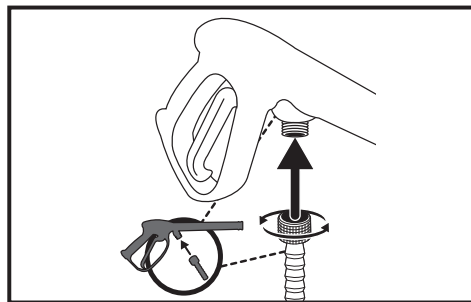

4 Connect Spray Wand to Spray Gun
Thread the spray wand into the end of the spray gun.

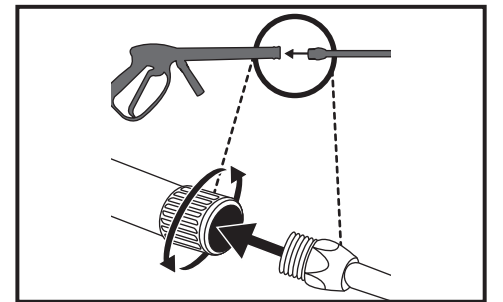

5 Connect QC Nozzles to Spray Wand
Pull quick connect coupler back and insert nozzle. Release quick connect coupler and twist nozzle to make sure it is secure in coupler.

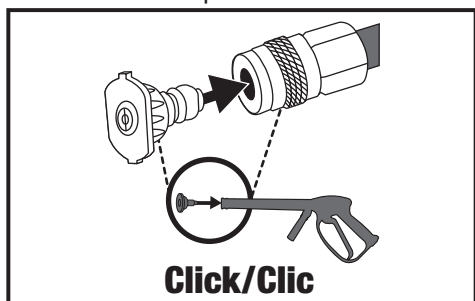

6 Turn Water Faucet Completely On
Do not run the unit without water supply connected and turned on. Use Cold Water Only.

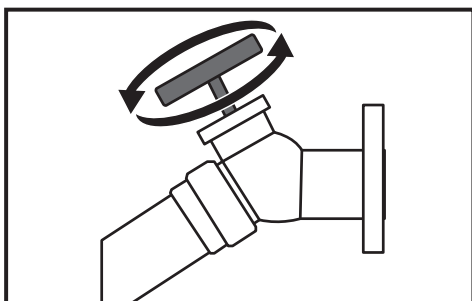

7 Release Air from System
Release all air from pump and high pressure hose by depressing trigger until a steady stream of water is present. Approximately 30 seconds.

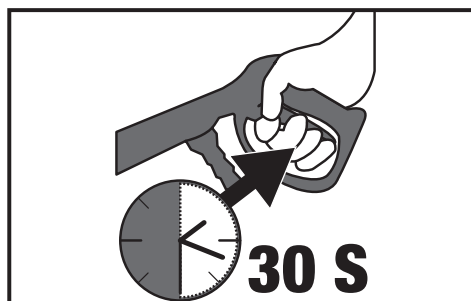

8 Verify the Fuel Valve is turned to the OPEN Position
The Fuel Valve has been preset by the factory to be in the OPEN position. See Label #8 on the side of the engine.

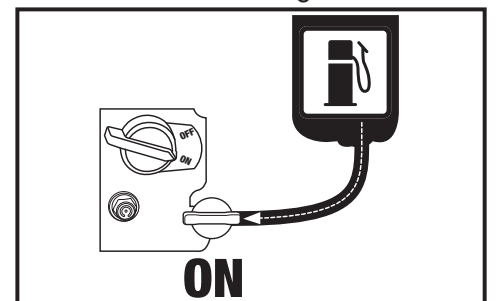

9 Verify the Engine Switch is turned to the ON Position
See Label #9 on the side of the engine.

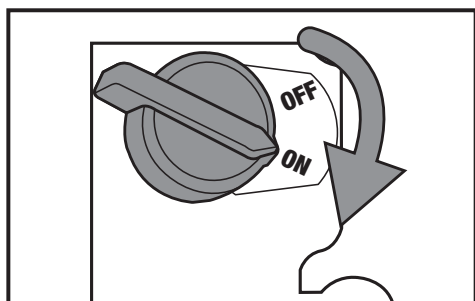

10 Verify the Choke Pin is Pulled Out to the CLOSED Position
The Choke Pin has been preset by the factory to be in the CLOSED Position. See Label #10 on the side of the engine.

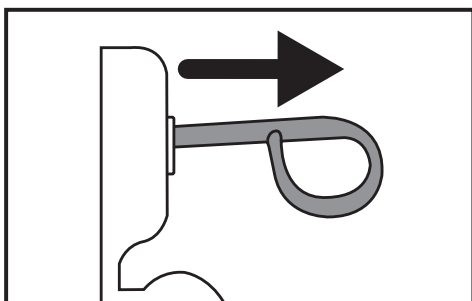

11 Pull the Recoil Starter Grip
Pull the recoil starter grip to start the engine. See Label #11 on the side of the engine.

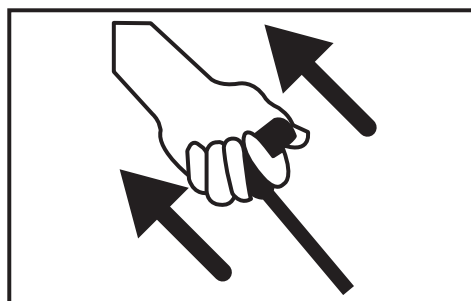

12 Push the Choke Pin to the OPEN Position
Gradually move the Choke Pin to the OPEN Position after engine starts. See Label #12 on the side of the engine.

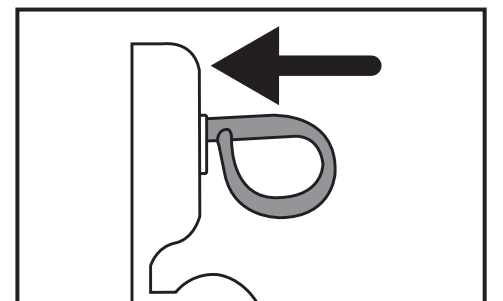

WARNING: This Guide is not a substitute for reading the operator's manual. User must read and understand operator's manual before using this product.